

Palm Beach
51-55 BYNYA ROAD





palmbeachrealestate.com.au



Rare 2753sqm Estate, 3 Separate Titles Spectacular Ocean & Whale Beach Views

Under instructions from the Trust Company Australia Limited is this rare opportunity to secure one of the largest undercapitalised parcels of land available in Palm Beach.

Consisting of three separate titles to be sold in one line and including an original sandstone cottage, this elevated 2,753sqm landholding presents endless possibilities in a premier location.

The property captures dramatic ocean views of truly breathtaking magnitude from a sublime cliff top position surrounded by trees which directly overlooks Palm Beach to Bangalley Head and provides unlimited scope to fully restore, subdivide or redevelop (STCA). The existing cottage has until recently been occupied by the one family for many decades and can be lived in now

while planning to potentially further capitalise in the near future.

Unprecedented in size, scope and scenic grandeur, this magnificent estate promises a lifestyle of exceptional privacy, with pristine peninsula beaches and Pittwater's boating playground minutes away and the heart of Sydney within a one hour leisurely drive. Opportunities like this seldom present themselves.

AUCTION Tuesday 24th November, 2009 at 10.30am, Raine and Horne Auction Centre, 55 Harrington Street, The Rocks.

 **3**  **1.5**  **3+**

Land Size: 2,753.8 sqm
Council Rates: \$2,876 per quarter (approx)
Water Rates: \$150 per quarter (approx)
View: As advertised or by appointment
Contact: Raine & Horne Palm Beach
Glenn Lee 0416 205 996
Henty Real Estate
Harriet France 0408 93 63 73



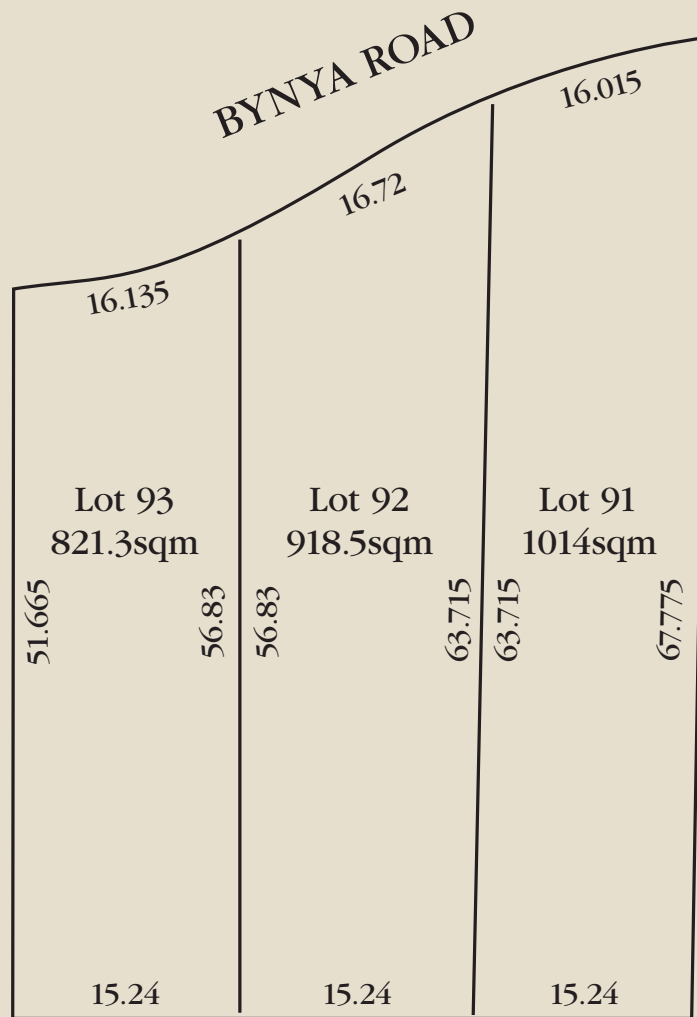

Total Area 2,753sqm

All information contained herein is gathered from sources we deem to be reliable. However we cannot guarantee its accuracy and interested persons should rely on their enquiries.



Palm Beach 9974 4311